

# Property Data Sheet

2224 Pleasant View Road  
Middleton, WI 53562



This 47,000 sf multi-tenant industrial/flex and office building features a PEMB building construction with architectural brick, varying office build-out, 18'+ ceilings, 6 loading docks, 5 drive-in-doors, and ample parking.



## Property Availability/Details

Building Size:	47,000 sf
Site Size:	2.00 acres
Tenancy:	Multi-Tenant (3)
Vacancy (1/1/23):	42.66%
Loading Docks:	6
Drive-In-Doors:	5
Ceiling Heights:	18'+
Office Space:	Yes
Sprinkler System:	No
Year Built:	1995

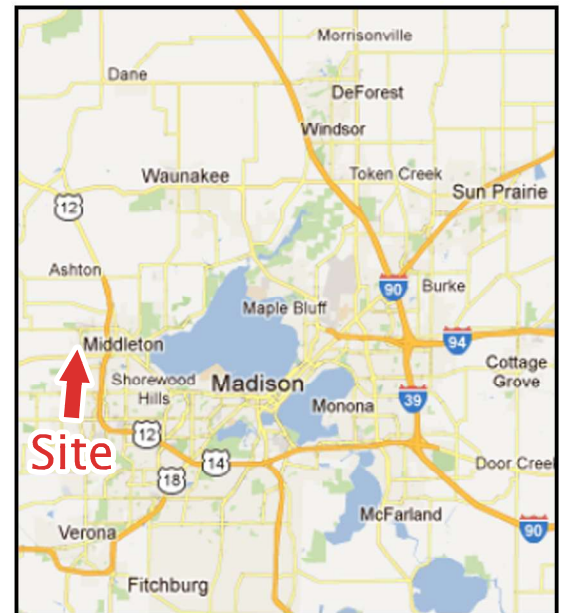

**Contact Info:** Paul Molinaro  
Direct: (608) 661-8803  
Cell: (608) 628-5427  
paulm@buildtosuit.com

[www.buildtosuit.com](http://www.buildtosuit.com)

# Property Data Sheet

2224 Pleasant View Road  
Middleton, WI 53562



## Floor Plan

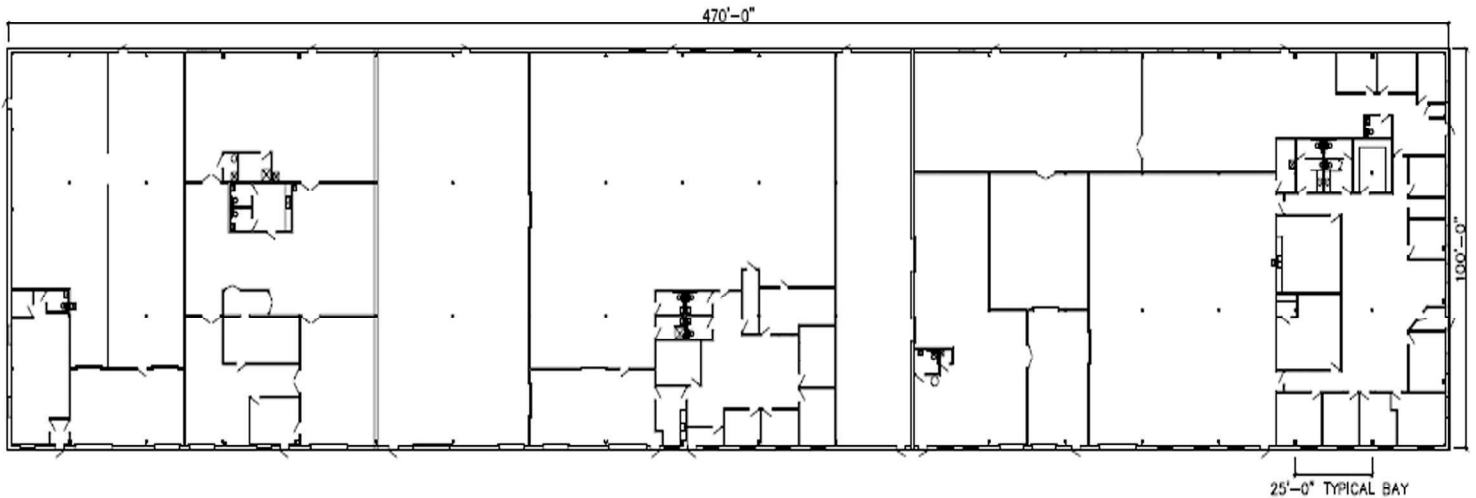

FLOOR PLAN- 2224 Pleasant View Road Middleton WI.

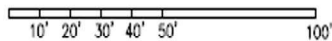

### Contact Info:

Paul Molinaro  
Direct: (608) 661-8803  
Cell: (608) 628-5427  
paulm@buildtosuit.com

[www.buildtosuit.com](http://www.buildtosuit.com)

# Property Data Sheet

2224 Pleasant View Road  
Middleton, WI 53562



## Site Plan

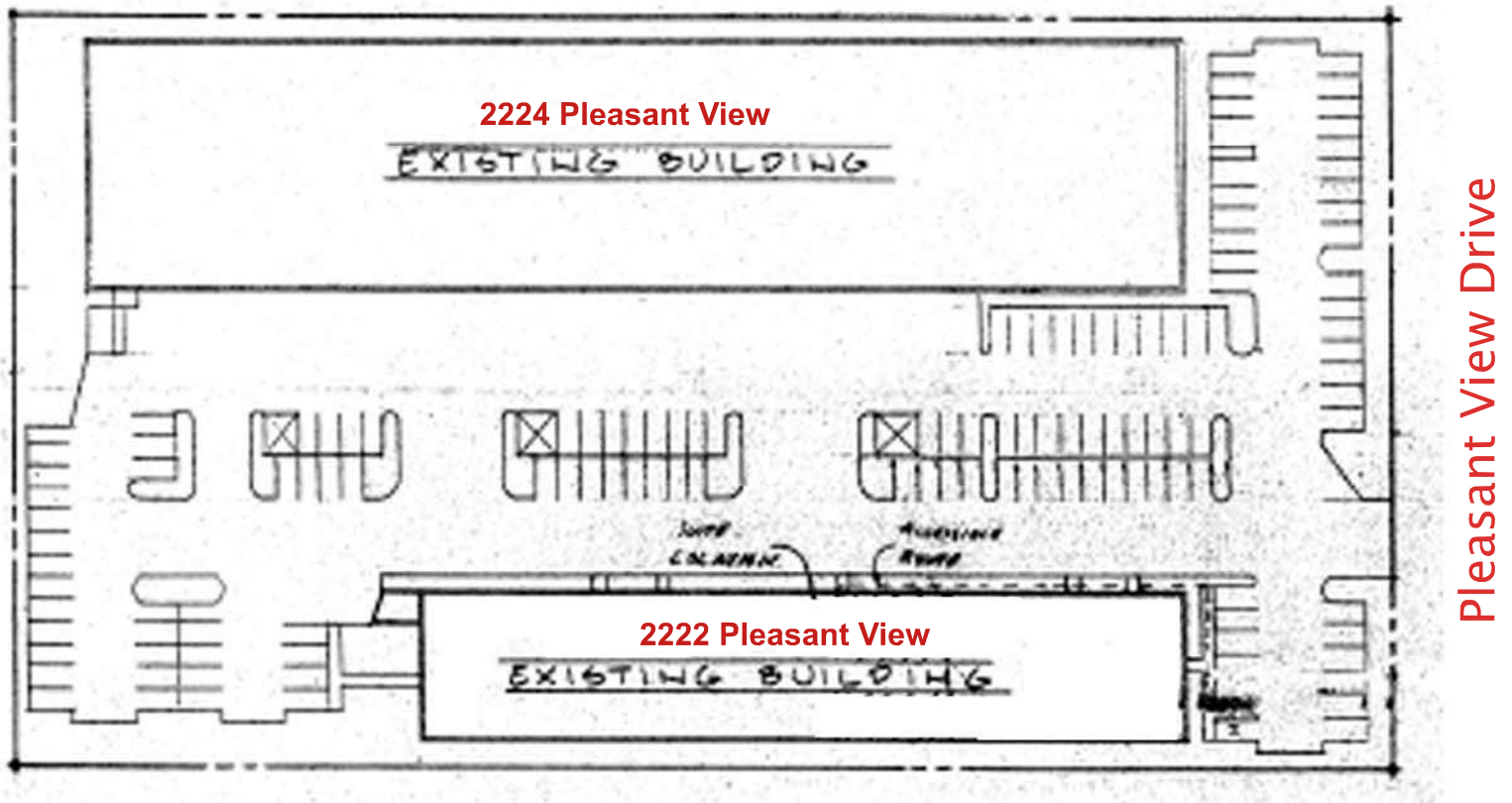

### Contact Info:

Paul Molinaro  
Direct: (608) 661-8803  
Cell: (608) 628-5427  
paulm@buildtosuit.com

[www.buildtosuit.com](http://www.buildtosuit.com)

# 2224 Pleasant View Road Submarket Aerial

